



Part Number

SC59-001

Strut Cap Washer/Bush

NOTE – Installation is always recommended by a competent technician. Failure to install properly may result in wear to strut cap or shock absorber shaft.

1. Install as per order in diagram
2. The MRR Adjustable nut will go on last if the shock absorber is an MRR adjustable shock absorber.
3. Make sure the strut cap is aligned as per OEM shock absorber to fit back into the vehicle. For alignment on the strut cap see diagram.



Not enough thread showing. The top bush may appear tight as there is force against it from the coil spring, however the bottom bush will still be loose.



The top bush and the bottom bush is tight now.

Dobinsons Springs and Suspension
Head Office – Rockhampton, AUSTRALIA
Brisbane – Sydney – Melbourne - Adelaide

admin@dobinsons.com

USA
sales@dobinsonusa.com

UAE
Dubai.sales@dobinsons.com

SC59-001 STRUT CAP ASSEMBLY

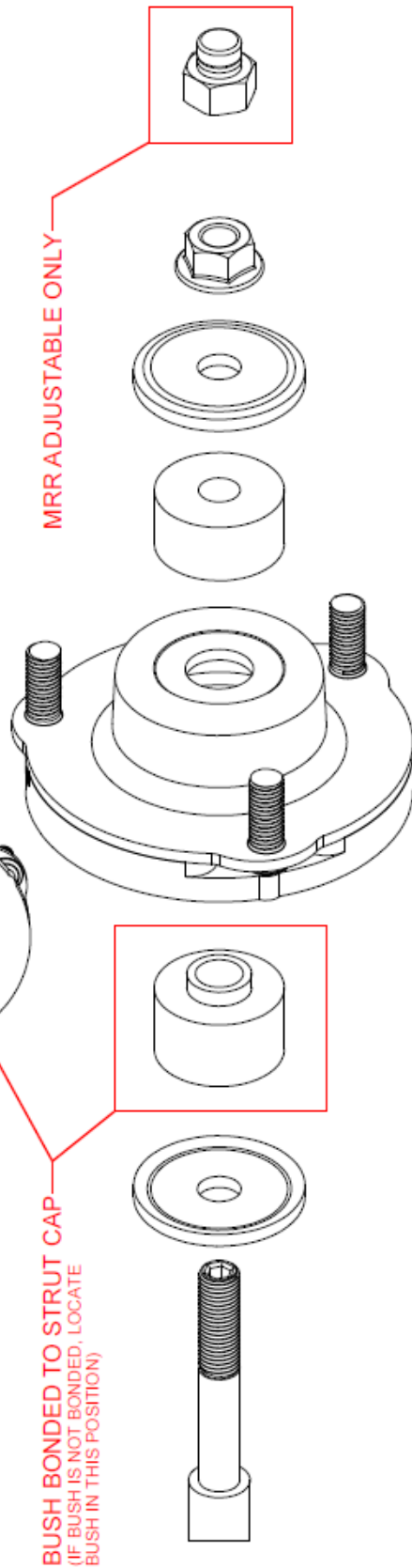

BUSH BONDED TO STRUT CAP
(IF BUSH IS NOT BONDED, LOCATE
BUSH IN THIS POSITION)

MRR ADJUSTABLE ONLY

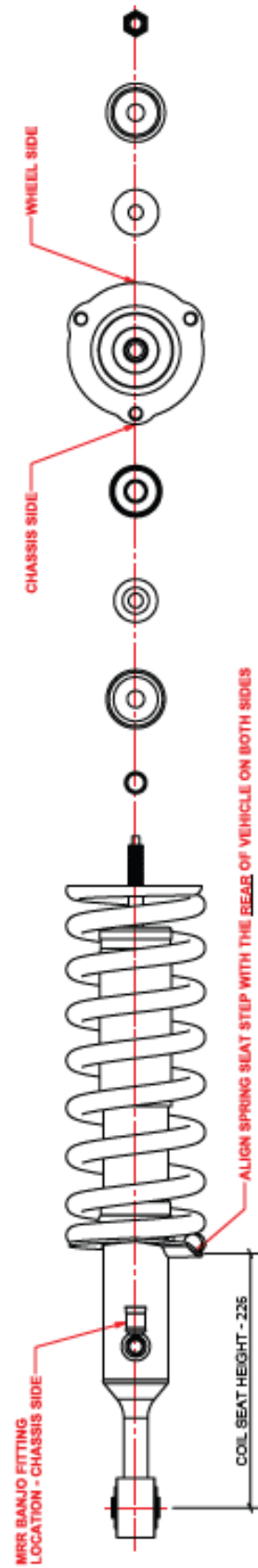

MRR BANK/O FITTING
LOCATION - CHASSIS SIDE

WHEEL SIDE

CHASSIS SIDE

ALIGN SPRING SEAT STEP WITH THE REAR OF VEHICLE ON BOTH SIDES

COIL SEAT HEIGHT - 225

TOYOTA HILUX (2005-ON)
RIGHT HAND STRUT SHOWN

Dobinsons Springs and Suspension
Head Office – Rockhampton, AUSTRALIA
Brisbane – Sydney – Melbourne - Adelaide

admin@dobinsons.com

USA
sales@dobinsonusa.com

UAE
Dubai.sales@dobinsons.com